

XL

Economy Heavy Duty Passthrough Dishwasher – 500mm Rack **W 750mm x D 765mm x H 1530mm**

Washtech's XL is a powerful, highly durable, simple-to-use and easy-to-maintain passthrough dishwasher. With one of the industry's lowest water consumption rates along with leading rinse heating, the XL provides excellent wash results in less time, while being light on operating costs and the environment.

The XL features Washtech Hybrid Controls which combine IP65 stainless switches, tried-and-tested switchgear, with a customisable electronic timer.

Since 1981 Washtech dishwashers have been constructed from heavy-duty stainless steel, and are engineered specifically for Australian conditions and regulations. Backed by the most extensive service network and spare parts inventory in the region, your Washtech dishwasher will not let you down.

Standard Features

- Autostart on hood closure 40, 60 and 90 second cycles
- Washes up to 1,620 plates per hour or 2,250 glasses per hour
- Low hot water consumption of 2.4 litres per cycle
- Washtech Hybrid Controls
- Self cleaning cycle
- Easy Installation supplied complete with:
 - Water supply hose
 - Detergent and rinse aid pumps with injector lines
 - No commissioning required
- Heavy-duty stainless steel construction and wash manifold
- Robust stainless steel wash and rinse arms with precision stainless steel jets
- Double heavy duty stainless steel filtration system including dual scrap trays and separate wash inlet filter
- Watermark approved backflow prevention
- Comprehensive 5-2-1 warranty

Includes:

- 2 x 600 70028 – 500mm dish rack
- 1 x 600 70029 – 500mm cup rack
- 1 x C660508 – cutlery basket
- 1 x C660503 – cutlery container



XL

Economy Heavy Duty Passthrough Dishwasher – 500mm Rack W 750mm x D 765mm x H 1530mm

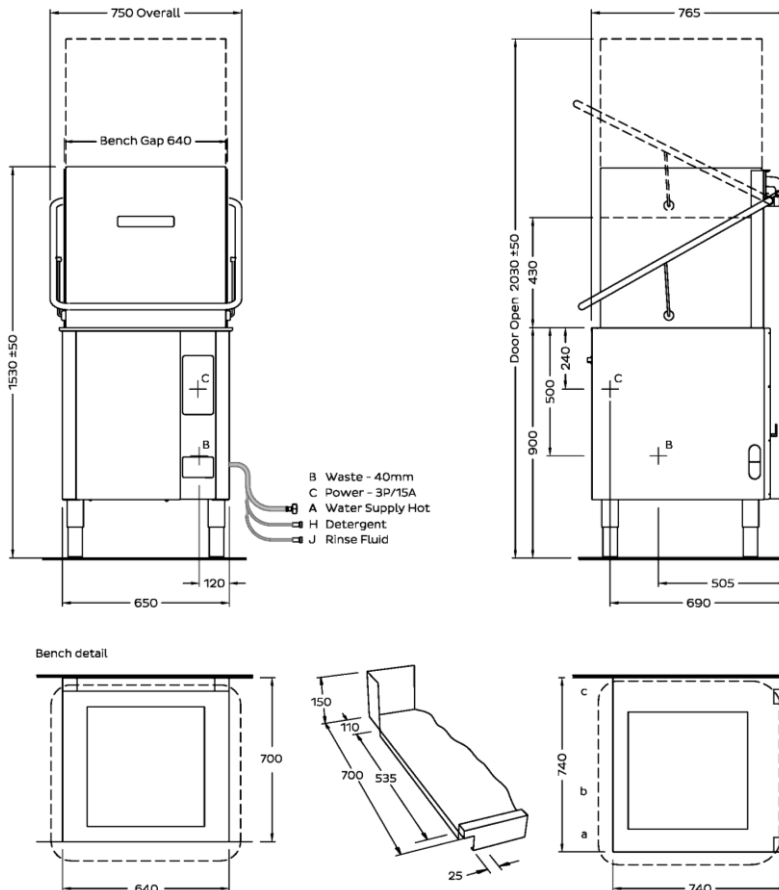

moffat.com.au

Australia
Moffat Pty Limited

Victoria/Tasmania
740 Springvale Road
Mulgrave, Victoria 3170
Telephone 03-9518 3888
Facsimile 03-9158 3833
vsales@moffat.com.au

New South Wales
Telephone 02-8833 4111
nswsales@moffat.com.au

South Australia
Telephone 03-9518 3888
vsales@moffat.com.au

Queensland
Telephone 07-3630 8600
qldsales@moffat.com.au

Western Australia
Telephone 08-9202 6820
wasales@moffat.com.au

A Hot water	Temperature	65°C			
	Connection	3/4" male; hose supplied			
	Pressure	200-350kPa			
	Flow	20 litres per min			
	Quality	Potable – refer table			
	Backflow Prevention	Atmospheric Vacuum Breaker			
	Consumption	2.4 litres per cycle*			
B Waste	Connection	1.5" BSP			
	Line	2" BSP			
C Electrical	V	Hz	A/phase	max kW	
	Three Phase	415	50	15	9.00

Dimensions	Machine	Packed
Width	750	800
Depth	765	950
Height	1530	1475
Weight	120	141
Cubicmetres		1.1

Water Quality	Min	Max
pH	7	8
Hardness ppm	20	100
Cl ⁻		100
SO ₄		400
Fe		0.1
Mn		0.5
Cu		0.05
Cl ₂		0.1

Corner Installation Notes:

- a. Machine must face left for easy access to controls
- b. Allow 300 clearance to front for service access
- c. Splashback return must be no higher than 150

Refer operator manual for installation instructions. Isolating switch must be within 1m of, and not directly behind the machine. Isolating water valve must be readily accessible.

*Consumption may vary with site conditions.



ISO9001
All Washtech products are designed and manufactured by Washtech using the internationally recognised ISO9001 quality management system, covering design, manufacture and final inspection, ensuring consistent high quality at all times.

In line with policy to continually develop and improve its products, Washtech reserves the right to change specifications and design without notice.



© Copyright Moffat Ltd
Version: 1806

an Ali Group Company



The Spirit of Excellence